

Parcel: 28-00179-000

Year: 2023

JACKIE MCKEE

Holmes County Auditor | Holmes County, Ohio



SUMMARY

Table with property details: Deeded Name (PORTER FARMS LLC), Owner (PORTER FARMS LLC), Tax District (28-WASHINGTON TWP-W HOLMES SD), Land Use (111-CASH-GRAIN OR GENERAL FARM), School District (WEST HOLMES SCHOOL DIST), Location (13937 SR 226), CD Year (2023), Acres (41.6500), Map Number (Sold), W-30 (05/24/2019), Routing Number (0033000), Sales Amount (390,900.00)

VALUE

Table with value details: District (28-WASHINGTON TWP-W HOLMES SD), Land Use (111-CASH-GRAIN OR GENERAL FARM "QUALIFIED FOR CURRENT AGRICULTURAL USE VALUE")

Table with columns: Appraised, Assessed. Rows: Land (271,800 / 95,130), Improvement (104,900 / 36,720), Total (376,700 / 131,850), CAUV (52,560 / 18,400), Homestead (0 / 0), OOC (0 / 0), Taxable (157,460 / 55,120)

CURRENT CHARGES

Table with current charges: Full Rate (57.850000), Effective Rate (45.679084), Qualifying Rate (38.888556)

Table with columns: Prior, First, Second, Total. Rows: Tax (1,326.77 / 1,130.67 / 1,172.81 / 3,630.25), Special (3.36 / 1.00 / 1.00 / 5.36), Total (1,330.13 / 1,131.67 / 1,173.81 / 3,635.61), Paid (1,330.13 / 1,131.67 / 1,131.67 / 3,593.47), Due (0.00 / 0.00 / 42.14 / 42.14)

TRANSFER HISTORY

Table with transfer history: Date, Deed Type, Sales Amount, Valid, # of Properties. Rows include transfers from 05/24/2019, 05/09/2017, and 01/01/1990.

LAND

Table with land details: Type, Dimensions, Description, Value. Rows: H-HOMESITE (1.0000, 26,800), RW-RIGHT OF WAY (0.6500, 0), T-TILLABLE (40.0000, 245,000), Total (271,800)

DWELLING

Table with dwelling details: Card 1, Style (01-SINGLE FAMILY), Family Rooms (0), Heating (Y), Stories (1.50), Condition (A-AVERAGE), Cooling (N), Rec Room Area (0), Year Built (1930), Grade (C), Finished Basement (0), Year Remodeled (0), Fireplace Openings (0), Rooms (0), Full Baths (1), Fireplace Stacks (0), Bed Rooms (0), Half Baths (0), Living Area (1,456), Dining Rooms (0), Other Fixtures (0), Total Area (2,562), Value (86,600)

OTHER IMPROVEMENT

Card	Type	Year Built	Year Remodeled	Condition	Dimensions	Description	Size	Value
1	CORN CRIB	OLD		P-POOR	16 X 13	Length x Width (Optional)	208	100
1	IMPL SHED-IMPLEMENT SHED	1930		VP-VERY POOR	20 X 20	Length x Width (Optional)	400	200
1	IMPL SHED-IMPLEMENT SHED	1982		A-AVERAGE	60 X 80	Length x Width (Optional)	4,800	16,300
1	SHED	1995		A-AVERAGE	14 X 16	Length x Width (Optional)	224	1,700
							Total	18,300

SKETCH

Card 1

ID	Description	Size	Floor	Floor Area (ft ²)	Living Area (ft ²)
A	1.5SFR/B (1.5 STORY SFR / B)	504	First Floor	1,204	1,204
B	1SFR/.5B (1 STORY SFR / .5B)	700	1/2 Upper Floor	504	252
C	CNPYSH (SHED TYPE CANOPY)	72	Basement	854	0
D	OFF (OPEN FRAME PORCH 1ST LEVEL)	70	Total	2,562	1,456
1	IMPL SHED-IMPLEMENT SHED	4,800			
2	SHED	224			
3	IMPL SHED-IMPLEMENT SHED	400			
4	CORN CRIB	208			

4

2

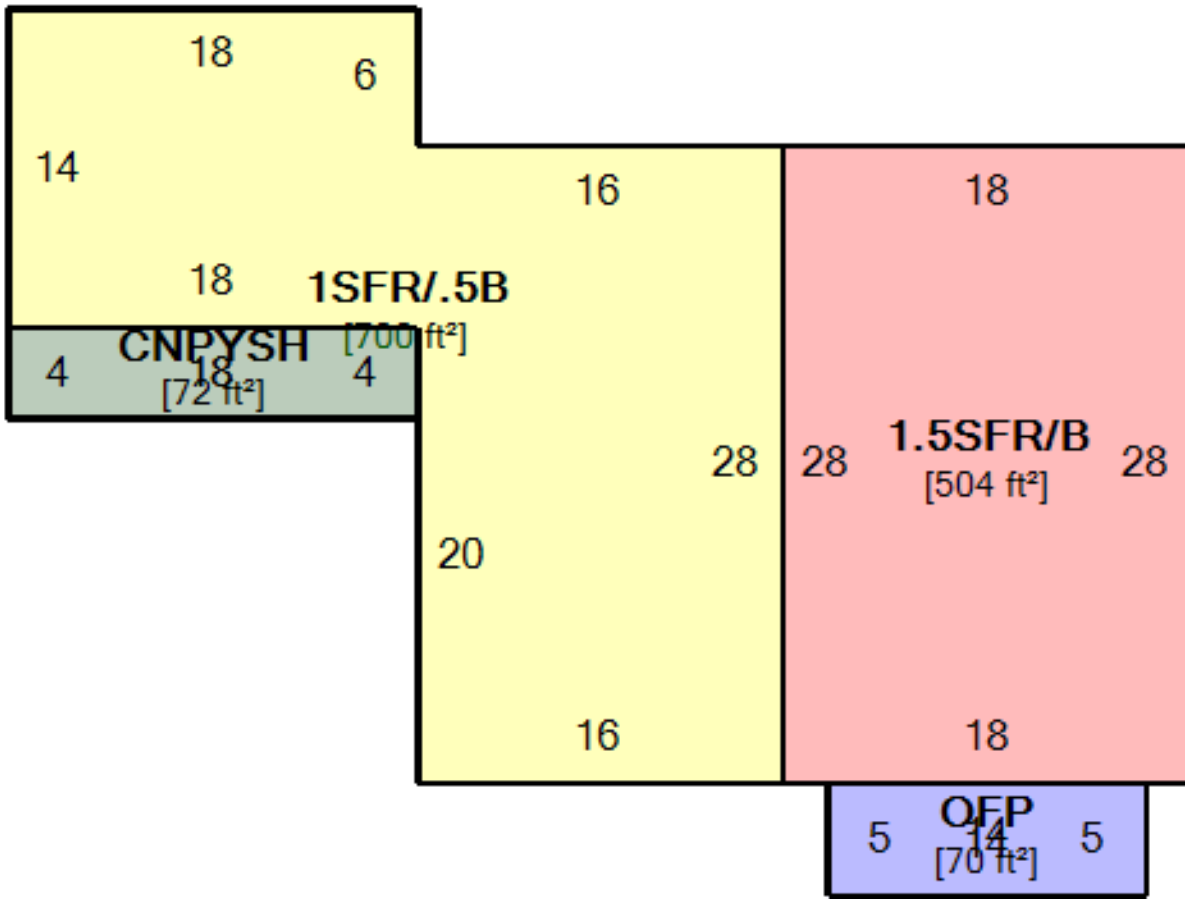

1

3